

DESCRIPTION

Nascom's DBI75 Series is a 3/8" recessed quick connect wide gap contact which protects all nonferrous (e.g. wood, aluminum and vinyl) doors and windows in both residential and commercial settings. DBI stands for "Designed by Installer."

The DBI75 is the installer's choice of contact configuration for salt air environments and maximum air and side-to-side gaps are required to prevent false alarms caused by shifting or warping doors and windows.

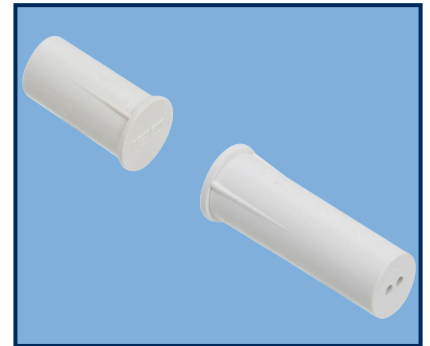

FEATURES

- PRESS FIT - NO GLUE REQUIRED
- GEL FILLED TERMINAL BLOCK
- FAST CONNECTION
- WIDE GAP - N35 NdFeB RARE EARTH MAGNET
- ENCAPSULATED HERMETICALLY SEALED CONTACTS
- ABS HOUSINGS
- LISTED TO UL634 STANDARD

ORDERING INFORMATION

PART NUMBER	COLOR	OPERATE GAP (in inches)	CONTACT RATING (Max DC/Peak AC Resistive)				STATIC CONTACT RESISTANCE (50mV, 100mA)
			SWITCHING		CARRY		
			V	I	V	I	
CLOSED LOOP, NORMALLY OPEN, 1FA, SWITCH/MAGNET SET:							
DBI75B/ST DBI75G/ST DBI75W/ST	BROWN GREY WHITE	0.625 to 1.00	200 VDC	0.5 Amps	10vA	1.5 Amps	150 mOhms

WIRING SCHEMATIC

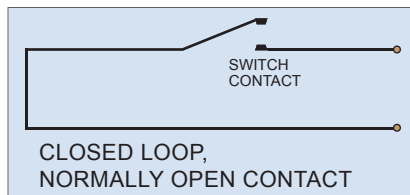

DIMENSIONS - IN [mm]

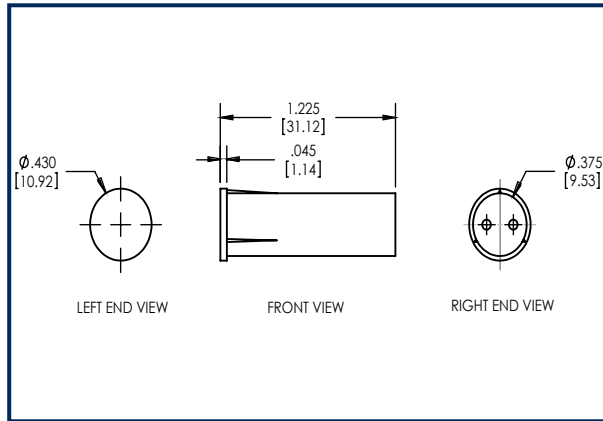
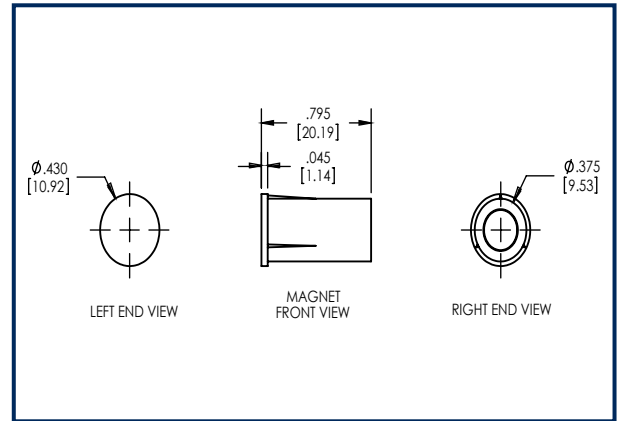
SWITCH

MAGNET

INSTALLATION INSTRUCTIONS

- Mark location for the switch on the door frame and mark the location for the magnet on the top edge of the door.
- Make sure switch and magnet hole locations are aligned.
- Using a square, transfer the marks on to the top edge of the door and the opposing door frame.
- Using a tape measure or graduations on the square, locate the center of the door edge and place an intersecting line with the first mark. Drill a 3/8" hole at the location where the marks intersect.
- Repeat the above step to locate the hole position for the switch in the door frame. Drill a 3/8" hole in the door frame.
- Using 22awg solid or stranded wire stripped to 1/8", insert stripped wire leads in gel filled terminal block.
- Press the magnet into the hole you drilled in the door until flush with top edge of door.
- Insert wire leads into hole followed by the switch and press the switch into the hole until the head is flush with the door frame
- Test switch for correct operation and make sure gap performance is acceptable.

PART NUMBERING SYSTEM