

DESCRIPTION

Nascom's N808200AU Tilt Gate Switch is designed to protect tilt gates and sliding gates that can have excessive side to side movement. The tilt gate switch has approximately six inches of No Dead Spot™ technology and a large NdFeB rare earth universal mount magnet to prevent false alarms in windy conditions.

The gap range for this switch is 1" to 2" because the magnet is generally oriented in the T configuration with the switch.



FEATURES

- **NO DEAD SPOT™ TECHNOLOGY**
- **EXTRA WIDE GAP - N35 NdFeB RARE EARTH MAGNET**
- **24" ARMORED CABLE LEAD PROTECTION**
- **UNIVERSAL MOUNT**
- **36" 22AWG WIRE LEADS**
- **EXTRUDED ANODIZED (TYPE II) ALUMINUM**

ORDERING INFORMATION

PART NUMBER	COLOR	OPERATE GAP (in INCHES)	CONTACT RATING (Max DC/Peak AC Resistive)				STATIC CONTACT RESISTANCE (50mV, 100mA)
			SWITCHING		CARRY		
			V	I	V	I	
CLOSED LOOP, NORMALLY OPEN, 1FA, SWITCH/MAGNET SET:							
N808200AU/ST	SILVER	up to 2.00	200 VDC	0.5 Amps	10vA	1.5 Amps	150 mOhms

WIRING SCHEMATIC

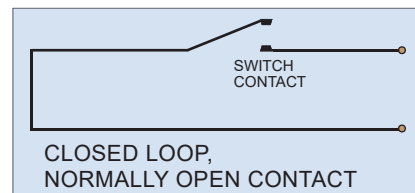

DIMENSIONS - IN [mm]

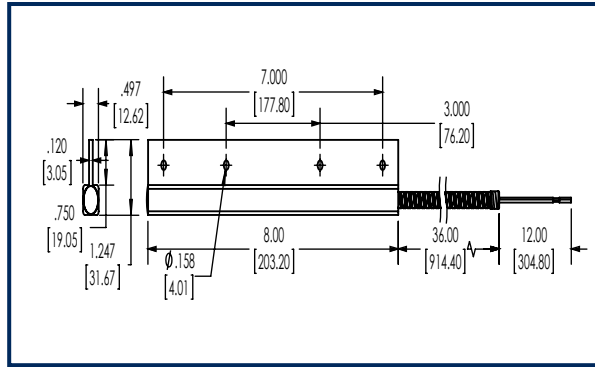

SWITCH

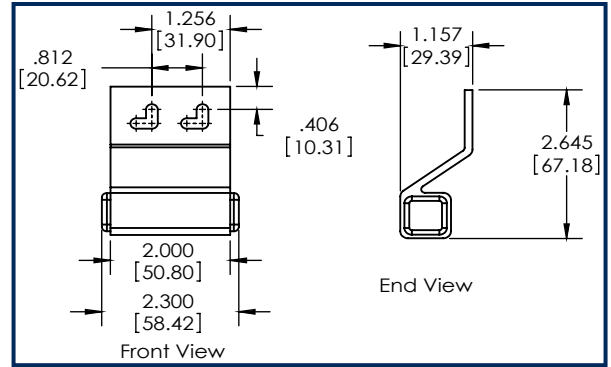

MAGNET

INSTALLATION INSTRUCTIONS

Nascom's Tilt Gate Switch is designed to mount in a T configuration with the gate to allow limited lateral movement of the gate in the closed position while maintaining the gate in a secure state:

- Position the switch on a suitable mounting surface such as the lower cross brace of the yoke with the switch centered on the gate. For best results the switch housing should be within one inch of the gate post.
- Mark the mounting hole locations and drill mounting holes using a drill bit adequately sized for a #6 self-tapping screw.
- Place the spacer under the switch and attach to the cross brace using four #6 self-tapping screws.
- With the gate in the closed position, locate the magnet on the gate post so the bottom end of the magnet is $\frac{1}{4}$ " above the switch and attach to the gate post using two #6 self-tapping screws.
- Connect an ohm meter to the switch leads and open and close the gate to test switch for correct operation. Connect the switch leads to the alarm system.
- Connect the switch leads to the alarm system.